

Feed-Mounted Pneumatic Rock/Concrete Drill
for mini-excavators, skid steer loaders, and most platforms
or with optional Two-Wheel Carriage



Take it anywhere!
TRAMAC's new versatile rock drill with light-weight twin air feed is powerful yet HIGHLY maneuverable—by just one operator.

- **High-performance pneumatic drill features Montabert drifter**
 - Drills holes up to 2 inches in diameter. Add steel for depths to 40 feet in all types of rock
 - Mounts to its own lightweight aluminum twin air cylinder feed
 - Drill orientation can be at any angle from horizontal to vertical
- **Single-operator use; adapts to almost any situation**
 - Ingenious special mounting clamp on the feed (see reverse side for sketch) adapts to a wide array of platforms: mini-excavators, skid steer loaders, rough terrain forklifts, cranes, man baskets, etc.
 - Optional two-wheeled carriage allows a single operator to easily move and position the entire assembly, even in remote locations—as simple as pushing a wheelbarrow
- **Simple, tough, economical, productive**
 - Rotary and percussive action for optimum hole production
 - Heavy-duty construction keeps maintenance low

Tramac's CFL drill is a simple, powerful rock drill that saves time and money and maximizes production on all sorts of jobs...

...vertical holes in stopes or quarry heads, horizontal lifter holes, trench blasting, mines, tunnels, construction sites, wherever you need to drill.

Easy for one operator to move and use, with its own twin air feed that clamps to a wide variety of platforms, fast and accurate response to remote controls, and light-weight optional two-wheeled carriage.



Pneumatic Rock/Concrete Drill



Pneumatic Rock Drill with Twin Air Feed

Specifications and Dimensions

ROCK DRILL (T28 CFL)			
Maximum bit diameter		<i>in/mm</i>	2 / 51
Shank	Standard	<i>in/mm</i>	1x4.25 / 25x108
	Optional	<i>in/mm</i>	7/8x4.25 / 22x108
Weight		<i>lb/kg</i>	62 / 28
Length		<i>in/mm</i>	27 / 685
Flushing	Air (Standard)	<i>cfm/lpm</i>	44 / 1250
	Water (Optional)	<i>gpm/lpm</i>	2 / 7
Rotation speed		<i>rpm</i>	250
Rotation maximum torque		<i>ftlb/Nm</i>	200 / 300
Strike frequency		<i>bpm</i>	2599
Bore		<i>in/mm</i>	3.5 / 90
Maximum stroke		<i>in/mm</i>	3.5 / 90
Total air consumption, rock drill		<i>cfm</i>	150
Rotation: c-clockwise standard, clockwise (for bolting) optional			

TWIN AIR FEED (AJA 205)			
Max. drilling depth		<i>ft/m</i>	39/12
with round or hexagonal rod			
Max. drilling depth		<i>in/m</i>	62 / 1.6
with integral steel (in multiples)			
Weight		<i>lb/kg</i>	143 / 65
Thrust	Forward	<i>lb/daN</i>	326 / 145
	Reverse	<i>lb/daN</i>	483 / 215
Length	Retracted	<i>ft/m</i>	8 / 2.47
	Extended	<i>ft/m</i>	13.9 / 4.27
Stroke		<i>ft/m</i>	5.85 / 1.8
Centralizer accepts 1 in. round or 7/8 in. hex			

Lightweight Drill Wagon

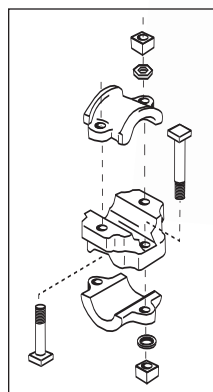
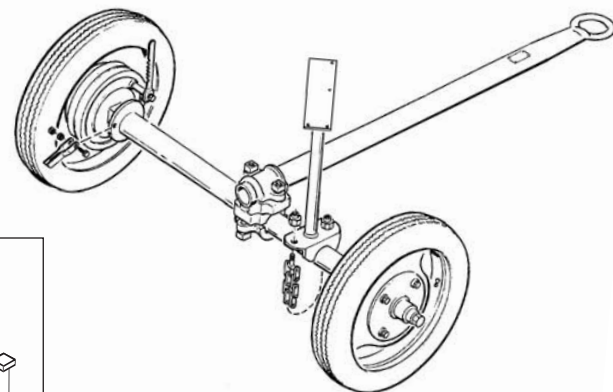

Detail of clamp

LIGHTWEIGHT DRILL WAGON			
Weight	Wagon alone	<i>lb/kg</i>	275 / 125
	Ready to drill	<i>lb/kg</i>	474 / 215
Maximum length		<i>ft/m</i>	9.1 / 2.8
Includes locking brakes, anchoring, control mount			

TRAMAC reserves the right to change or discontinue models and/or specifications without prior notice.

Dealer:

Quality and dependability: two features you can count on with every TRAMAC product.

All TRAMAC products are engineered for superior performance, manufactured to the most exacting specifications, and—within the guidelines of the industry's most rigid quality control program—thoroughly inspected at every stage of production. All working parts are precision-machined to the closest tolerances, and all materials meet or exceed the highest industry standards. These are but a few of the many vital reasons major contractors worldwide choose our products. *They know that with TRAMAC, reliability is crucial; a basic component conscientiously built into every unit that bears our name.*

